

ASPACE

REAL FURNITURE - FOR KIDS



Lexington 5 drawer chest 4111

PLEASE READ CAREFULLY & KEEP FOR FUTURE REFERENCE

Welcome

Thank you for buying this Lexington Chest of Drawers.

Before beginning assembly, please take a few quiet minutes to read these instructions.

Lay the parts out on a clean, soft, flat surface (such as a carpeted floor) and compare with the Parts Check list on the next page. Do not throw away any packaging until you are sure that you have all the parts.

If, for any reason, you wish to return the product, you must disassemble the components and use the original packaging.

Product care

- Clean your Chest of drawers by wiping with a damp cloth & drying with a soft cloth. Never clean with abrasives, chemical cleaners or household polishes.
- Take care when handling or moving the Chest of drawers. Careless handling can damage wooden furniture. Try to lift rather than drag.

Product safety

- Periodically check all fittings to ensure that none have come loose.
- The Chest of drawers must be set up on an even and stable surface.
- Keep away from direct sources of heat, such as electric, gas or coal fires.
- Do not allow children to climb on the furniture. Using this furniture other than for its intended purpose could cause damage to the structure or serious injury to your child.
- **Warning:** to avoid the risk of the chest tipping over in use, the anti-topple device supplied must be attached to the chest and wall as shown in these instructions.

If not fitted, take care that only one drawer is loaded or opened at a time.

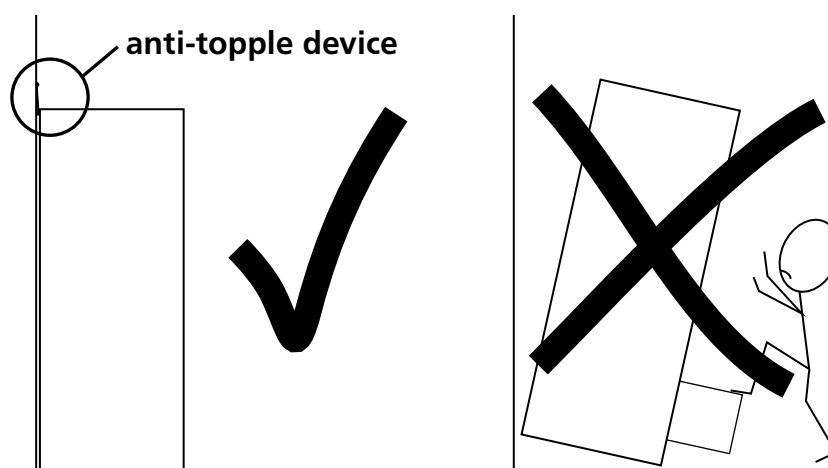

Customer service 0845 872 2400

If you have a problem with this product, please call our Customer Service team, who will be glad to help.

We can usually provide replacement and /or spare parts promptly; it assists if you can identify the specific part using the Check List in the next section.

Parts Check List

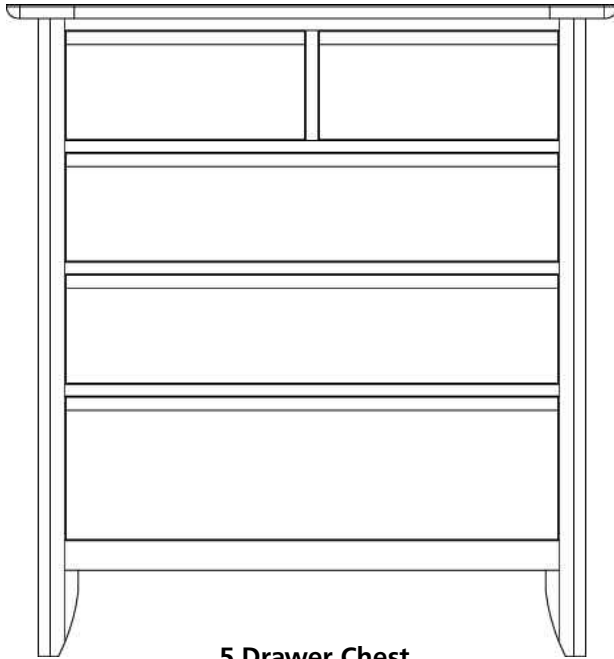

5 Drawer Chest

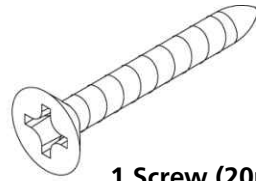

1 Screw (20mm)

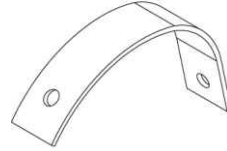

1 Wall strap

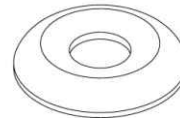

2 Washers

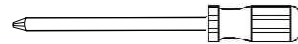

You will need a "Phillips" screwdriver

Assembly

1. Attach to the wall

You need:

1 Screw (20mm)

1 Wall strap

2 Washers

Screwdriver

This work is only to be carried out by a competent person. Because of the diverse nature of walls, wall plugs and screws have not been supplied with this anti-topple device. If you are at all unsure of the type or suitability of the wall, or of the appropriate fixings for it, seek professional advice.

Attach the wall strap to the rear of the top using the strap screw, inserted through one of the washers.

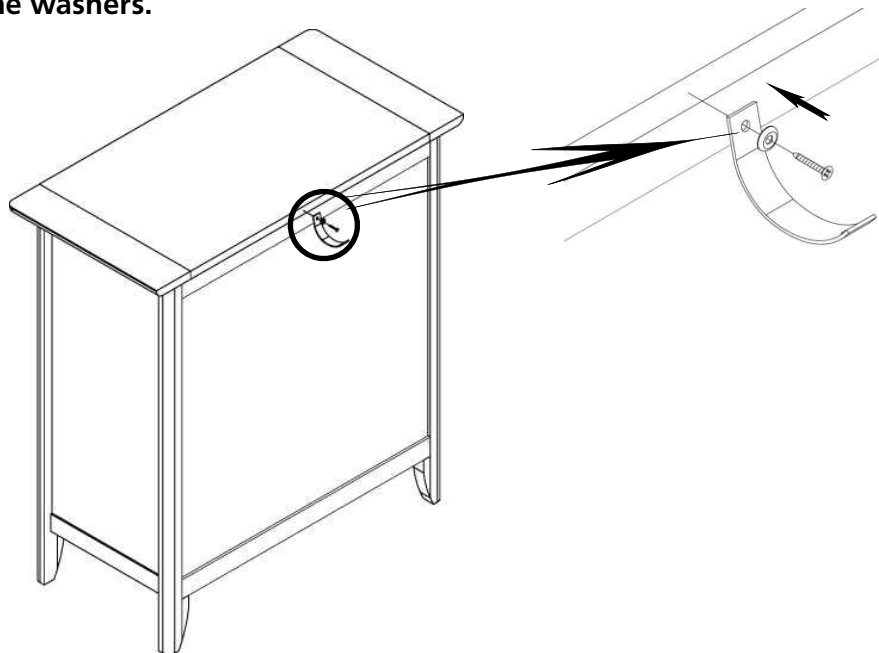

Move the chest into position, against the wall. Fix the other end of the strap to the wall, using fixing and screw appropriate for that wall.

